

Mode d'emploi - Cave à cigares  
User Manual - Cigar humidor  
Gebrauchsanweisung - Zigarren-Klimaschranks  
Gebruiksaanwijzing - Sigarenkast  
Modo de empleo - Cava de puros  
Istruzioni per l'uso - Armadi climatizzati per sigari  
使用手册 - 雪茄柜



EUROCAVE 



**1/ Description of your cigar humidor**

5



**2/ Power supply**

6



**3/ Protecting the environment – Eco-design**

6



**4/ Installing your cigar humidor**

- I- Unpacking / Precautions / Installation
- II- Attaching the handle / Door security
- III- Door reversibility

7

7

8

9

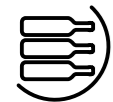

**5/ Layout – Storage**

11



**6/ Commissioning your cigar humidor**

- I- Connection
- II- Description
- III- Setting the temperature and relative humidity
- IV- Charcoal filter meter display
- V- Setting the lighting mode

12

12

12

12

13

13



**7/ Daily maintenance**

14



**8/ Operating faults**

15



**9/ Technical features**

15

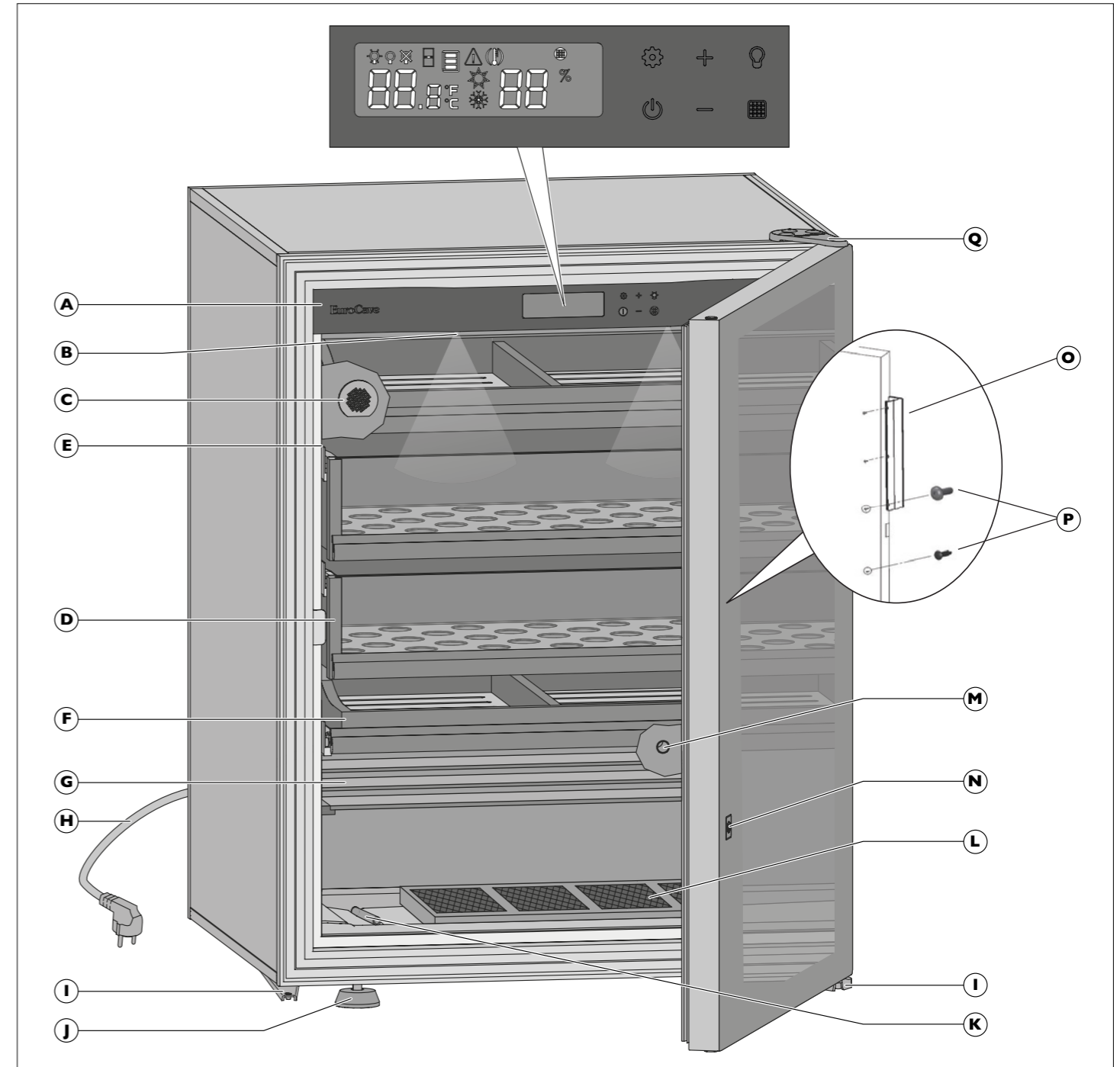

- |          |                                   |          |                                          |
|----------|-----------------------------------|----------|------------------------------------------|
| <b>A</b> | Control panel                     | <b>J</b> | 2 feet, adjustable in height             |
| <b>B</b> | Lighting                          | <b>K</b> | Drain tube                               |
| <b>C</b> | Breather hole and charcoal filter | <b>L</b> | 2 clay ball cassettes                    |
| <b>D</b> | Sliding drawer                    | <b>M</b> | Lower breather hole                      |
| <b>E</b> | Mood lighting (light strip)       | <b>N</b> | Dual-action lock                         |
| <b>F</b> | Display tray                      | <b>O</b> | Detachable handle (full glass door only) |
| <b>G</b> | 1/2 fixed shelf                   | <b>P</b> | Three screws, (full glass door)          |
| <b>H</b> | Power lead                        | <b>Q</b> | Upper hinge                              |
| <b>I</b> | 2 lower hinges                    |          |                                          |



## 2/ POWER SUPPLY

The cigar humidor's power lead is fitted with a plug to be connected to a standard socket, earthed to prevent any risk of electric shock.



Have your mains socket checked by a qualified electrician who will tell you whether or not it is correctly earthed and carry out, if necessary, work to make it compliant.

Contact your usual EuroCave stockist to replace the power lead if it is damaged. It must be replaced by a EuroCave original manufacturer's part.



If you move to another country, check whether or not the characteristics of the humidor correspond to the country (voltage, frequency).



**For your personal safety, the cigar humidor must be correctly earthed. Ensure that the socket is correctly earthed and that your installation is protected by a circuit breaker (30 mA\*).**  
\* not applicable to some countries.



## 4/ INSTALLING YOUR CIGAR HUMIDOR

### Unpacking

- When your humidor is delivered, check the outside for signs of damage (dents, buckling...).
- Open the door and check that the inside of your appliance is intact (walls, sliding shelves, sliding drawers, hinges ...).
- Remove any protective elements inside and outside your humidor, including the protective wedge for the lower hinge (see diagram (1)).
- Add the plug (see diagram (2)) located in your accessories sachet, used to cover the hole in the lower hinge.

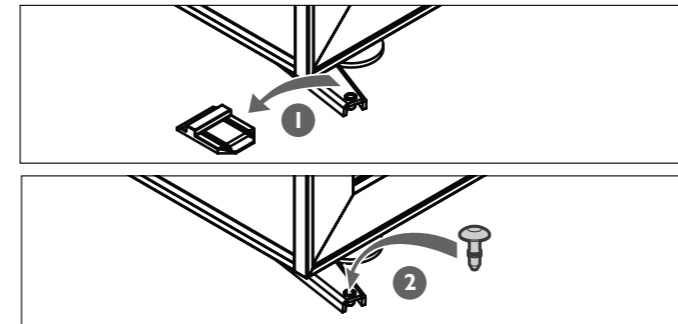

If you have any problems, contact your EuroCave stockist.



**When moving the humidor, do not tilt it more than 45° and always on the opposite side of the power lead.**

### Installation

Transport the humidor to your chosen location.

#### It must be:

- open to the outside to allow ventilation (not enclosed in a cupboard...),
- not be too damp (linen cupboard, utility room, bathroom...),
- have a flat, stable floor,
- have a power supply (standard socket, 16 A, earthed with circuit breaker, 30 mA\* (\* not applicable to some countries).



## 3/ PROTECTING THE ENVIRONMENT – ECO-DESIGN

Spare parts for our appliances are available for 11 years. For further information, contact your EuroCave stockist. For France, contact our customer service. Contact persons on [www.eurocave.com](http://www.eurocave.com).

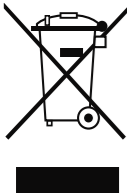

#### Disposing of packaging

The packaging used by EuroCave is made from recyclable material. After unpacking your humidor, take the packaging to a refuse collection point. For the most part, it will be recycled.

#### Recycling: a caring gesture

Electric and electronic equipment has potentially harmful effects on the environment and human health owing to the presence of hazardous substances. You should never therefore trash electric and electronic equipment with unsorted municipal waste.

When buying a new EuroCave product, you can entrust recycling of your old appliance to your EuroCave stockist. Speak to your EuroCave stockist, he will explain the removal and collection methods set up in the EuroCave network.

In accordance with legislation on protecting the environment, your cigar humidor does not contain C.F.C or H.C.F.C.

#### Saving energy

- Install your humidor in a suitable place (see next page) and observe the recommended temperature ranges.
- Keep the door open for as short a time as possible.
- Ensure that the door seal is in good condition and is not damaged. If it is, contact your EuroCave stockist.

Disable unusable appliances by unplugging them and removing the power lead.

### Precautions

- Do not install your humidor in an area likely to flood.
- Do not place your humidor close to a source of heat or expose it to direct sunlight.
- Do not allow water to splash on any part of the back of the appliance.
- If installing under a work top, leave a minimum gap of 5 cm all around the appliance including under the work top. Provide an air vent in the work top (as per Eurocave recommendation).
- Arrange the power lead so that it is accessible and does not come into contact with any of the appliance's components.
- Tilt the humidor backwards slightly in order to set the front feet (by screwing or unscrewing), in order to level your humidor (use of spirit level recommended).
- Check that the plastic tube of the drain pipe, located inside your humidor at the bottom on the left-hand side, is correctly positioned (see diagram below).

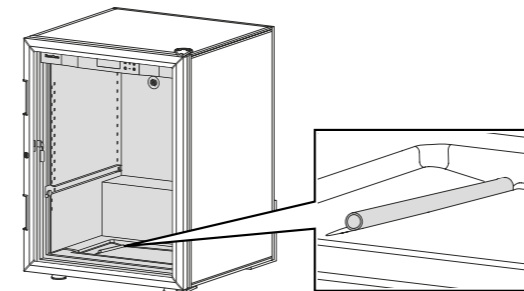

- Install the stop, found in the accessories sachet, at the back of the humidor (see diagram).
- This allows a gap of 7 cm to be maintained between the wall and the back of the humidor. This gap optimises your humidor's energy consumption.
- Insert the 2 plugs into the 2 holes at the top of the humidor.
- Do not push them all the way in, in order to allow the rear stop to be installed.
- Slide the rear stop between the plugs and the wall of the humidor, then push the 2 plugs all the way in.
- Next, place the two clay ball cassettes in the tray at the bottom of

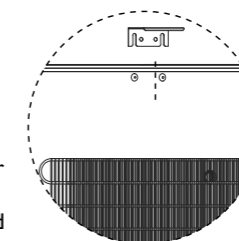

the appliance and attach them to each other using the pins (see diagram below).

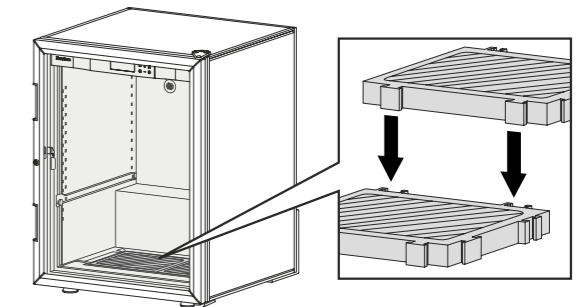

- Install the charcoal filter, found in the "accessories" sachet, by inserting it into the breather hole located inside your humidor, on the top left-hand side (see diagram below).

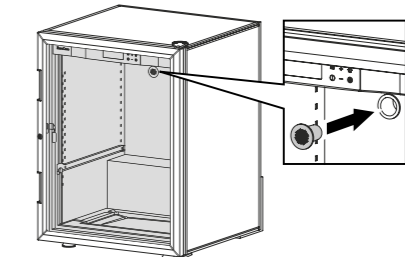

- When using your humidor for the first time, the charcoal filter alarm will display. Reset the filter meter to 365 (see chapter 6, § IV).
- Wait 48 hrs before plugging in the humidor.

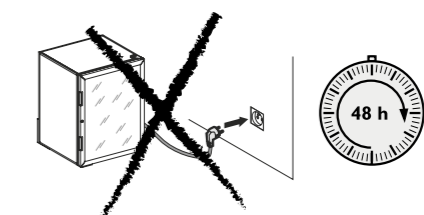



## 4/ INSTALLING YOUR CIGAR HUMIDOR

### Attaching the handle

(Full glass doors only)

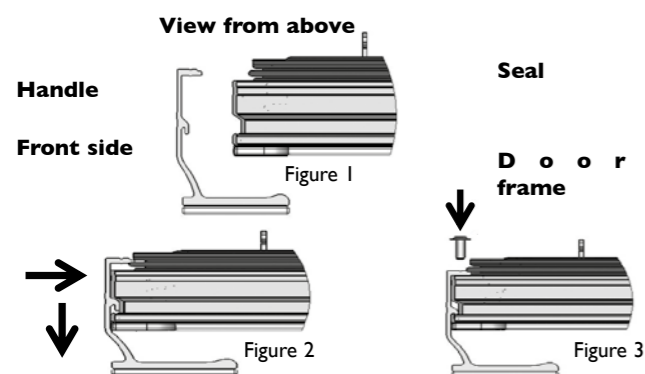

- Unscrew the three screws placed on the door frame, using the Allen wrench found in the handle's presentation box.
- Position the handle on the specially provided groove in the door frame (figure 2).
- Push the handle all the way into the groove using a forward movement (figure 2).
- Screw the three screws back in (figure 3).
- Take care not to crimp the seal when screwing.

Note: It is possible to adjust the handle thanks to the oblong holes.

### Door security

To secure your humidior, all doors come with a lock.



### Installation of two humidors side by side

Please note: In the case of two humidors installed side by side in extreme conditions (Temperature >30°C – Relative humidity > 70%), in order to prevent condensation caused by stagnant air between the walls, ensure that you leave a gap of at least 5 cm between the two humidors, or fill the space with a foam board to close the gap.



## 4/ INSTALLING YOUR CIGAR HUMIDOR

### III- Door reversibility

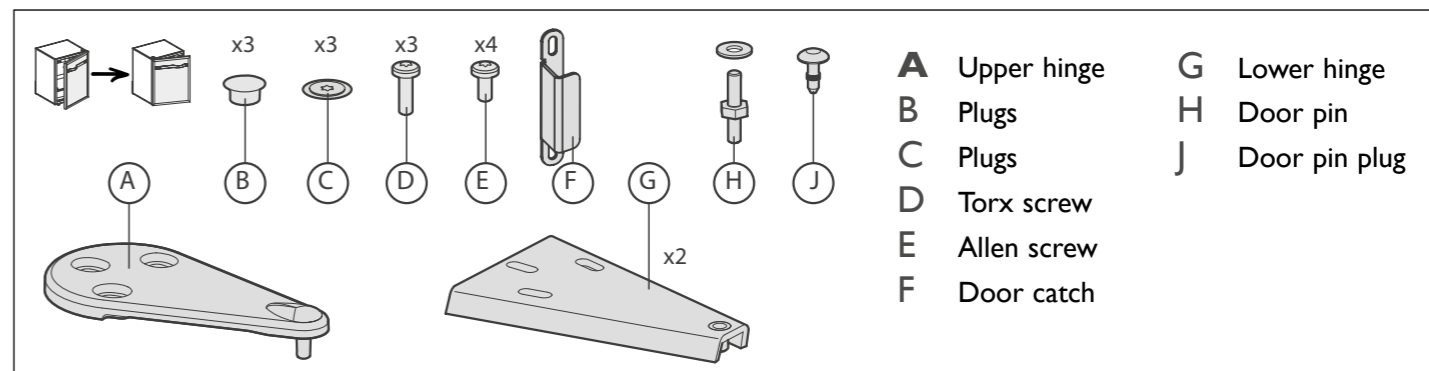

This allows you to change the direction of opening. Proceed as follows (example for changing a right-hand door into a left-hand door):

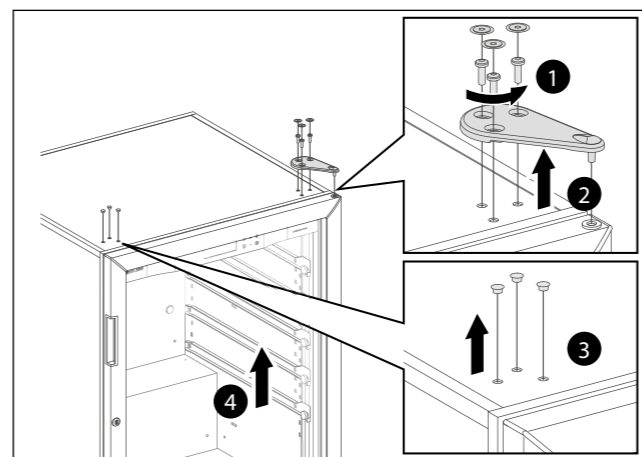

- 1 Unscrew the three screws using a "T25" Torx wrench.
- 2 Remove the upper hinge.
- 3 Carefully remove the plugs using a thin blade.
- 4 Remove the door of the humidior by opening it slightly, then lifting it upwards.

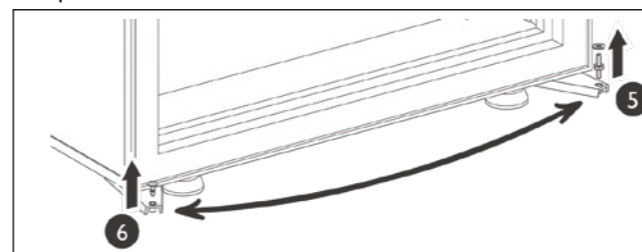

- 5 Unscrew the door pin.
- 6 Carefully remove the plugs using a thin blade and replace with the pin. Reposition the plug on the opposite side.

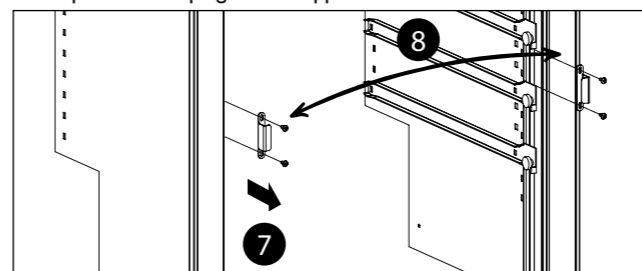

- 7 Unscrew the two screws and the door catch. Unscrew the two screws on the opposite side and remove the two washers.
- 8 Using the screws, fasten the door catch on the side you want the door to open. Replace the washers then the screws, on the side opposite the door catch.

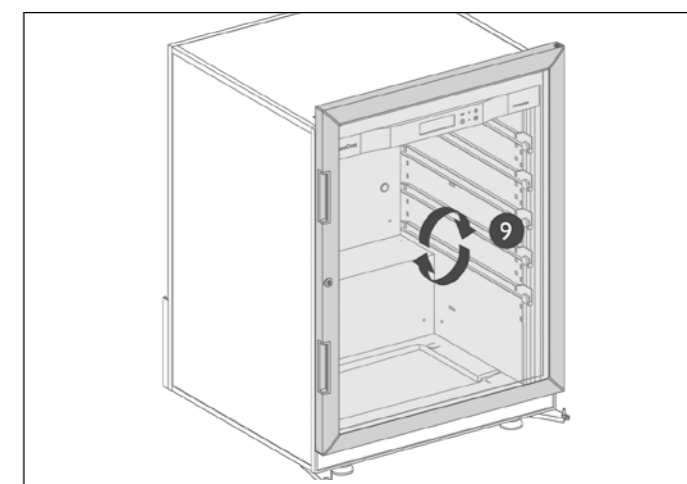

- 9 Turn the door through 180°.

**! N.B.:** the door is very heavy. Take all necessary precautions to ensure you do not injure yourself or drop it.

- 10 Put the door back on its pin.

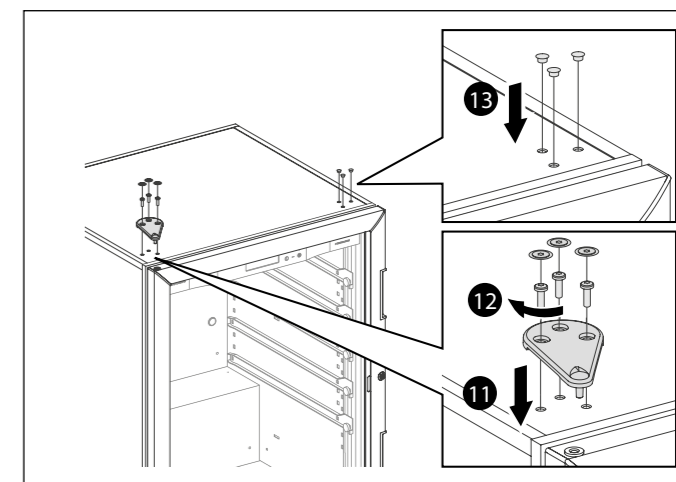

- 11 Put in place the upper hinge.
- 12 Screw the hinge in such a way that the door is completely parallel to the body of the humidior. Check that the seal adheres well to the humidior body (by closing the door), to ensure it seals effectively.
- 13 Put in place the plugs.



## 4/ INSTALLING YOUR CIGAR HUMIDOR

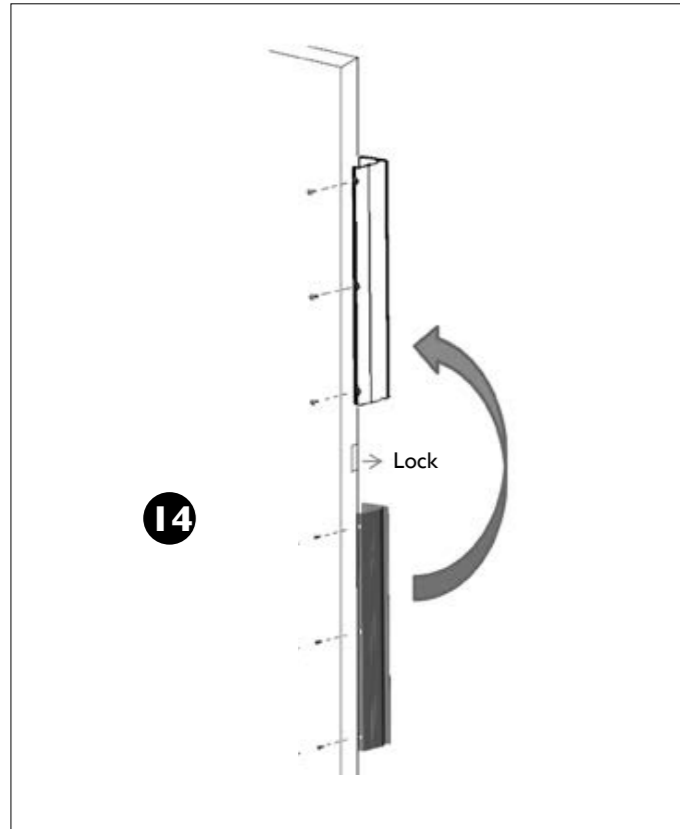

**14** As the door has been turned, reposition the handle above the lock (full glass doors only): Unscrew the six screws using the Allen wrench (2.5 mm) found in the handle's presentation box.

**15** Position the handle on the specially provided groove in the door frame. Push the handle all the way into the groove using a forward movement.

**16** Screw the six screws back in. Ensure that you do not crimp the seal when screwing.

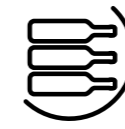
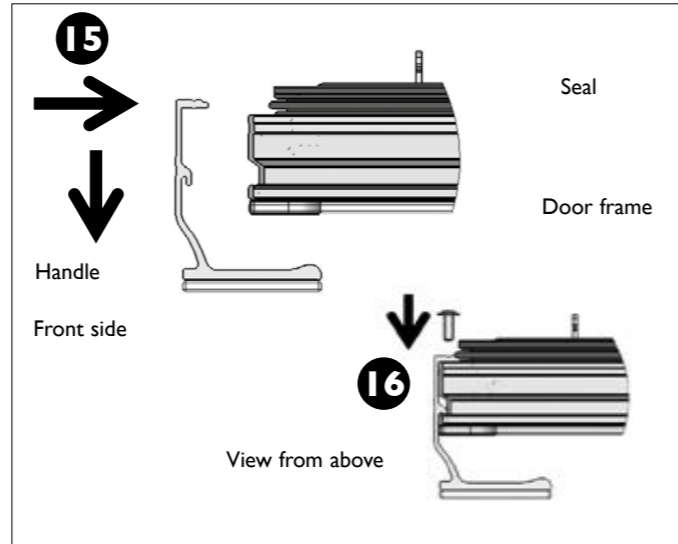

## 5/ LAYOUT – STORAGE



Your EuroCave cigar humidor is designed to be adaptable. Its storage equipment adapts to your requirements and can be added to over time.

### EuroCave cigar humidors have two types of storage, specially designed to hold cigar boxes

Your EuroCave cigar humidor is designed to safely hold a maximum number of cigars. We recommend that you observe the following advice in order to optimise loading.

- Ensure that you distribute your cigar boxes evenly, taking care to allow sufficient air circulation.
- Also, ensure that the loading density of your humidor is even (avoid storing the cigars all at the top or all at the bottom).
- If you have sliding shelves, it is preferable to position them at the top of the humidor to facilitate daily access.
- Likewise, place a small amount of each type of cigar in the display tray with compartments and store the rest in their boxes. You will then simply add to this tray whenever you smoke a cigar.

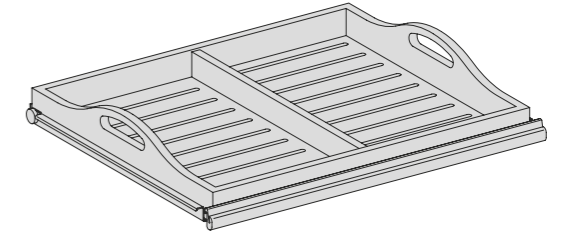

Sliding shelf + display tray - ref.APC

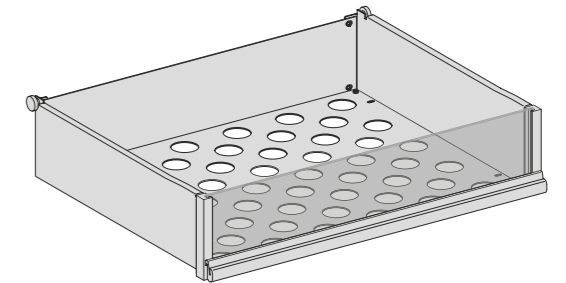

Sliding drawer - ref.ATC

### Changing the position of a sliding shelf

- Completely unload the sliding shelf.
- Next, remove the sliding tray by sliding it towards you whilst raising the front section.
- Remove the slide guides from the walls, marking off the left guide and the right guide.
- Now re-install them (see diagram below).

#### A. Putting in place the rear section of the guide

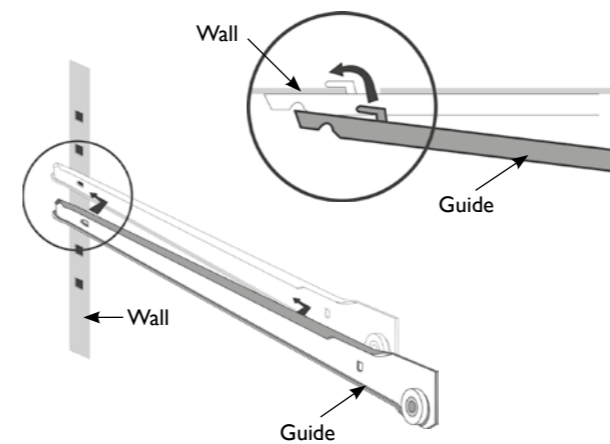

#### B. Putting in place the front section of the guide

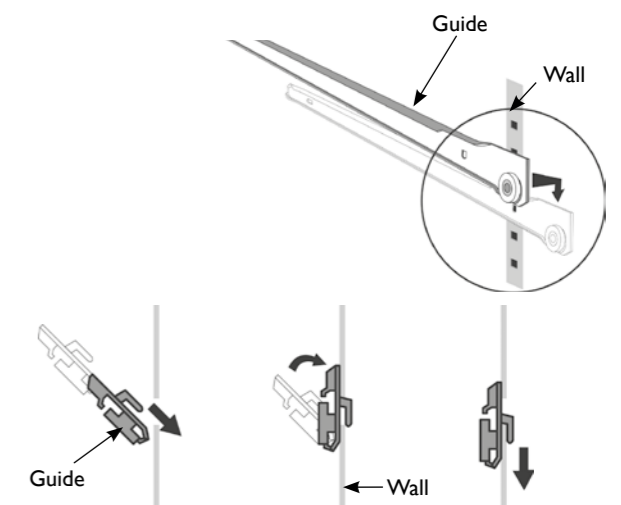

#### C. Next, replace the sliding shelf

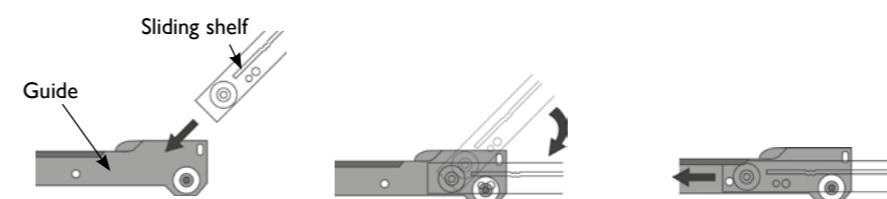



## I- Connection

Have your socket checked (presence of correct-sized fuses and 30 mA circuit breaker).  
Do not plug several humidors into a multi-socket adaptor.

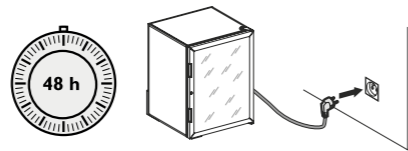

## II- Description

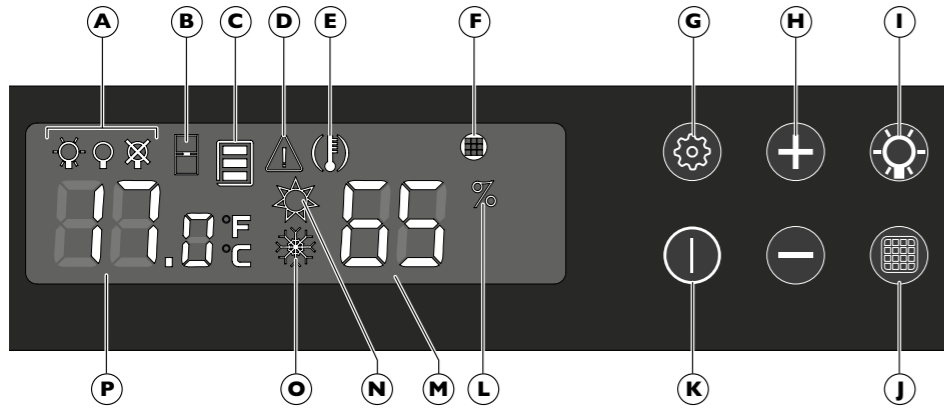

- |   |                                       |   |                                         |
|---|---------------------------------------|---|-----------------------------------------|
| A | Lighting mode                         | I | Lighting mode validation and access key |
| B | Open door alarm                       | J | Charcoal filter meter access key        |
| C | Temperature zone                      | K | Standby key                             |
| D | Sensor fault alarm                    | L | Humidity level alarm                    |
| E | Temperature alarm                     | M | Relative humidity level display         |
| F | Charcoal filter alarm                 | N | Hot circuit indicator                   |
| G | Validation and access to settings key | O | Cold circuit indicator                  |
| H | Setting and selection keys            | P | Temperature display                     |

The tactile keys are very sensitive. There is no need to apply force, a light touch is sufficient to register the command. Remember to remove your finger from the control panel between each press.

## III- Setting the temperature and relative humidity



Press the **I** key for 5 secs to start up.

**1** Press the key for approximately 5 secs.  
The display will start to flash.

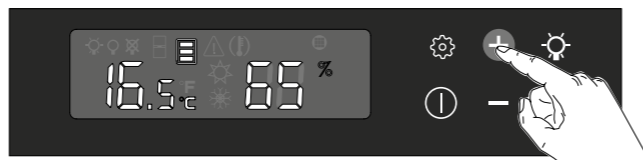

**2** Press the **+** or **-** keys to set the desired temperature.

The value shown on the display is the actual temperature inside the humidifier, it is therefore necessary to wait before your new setting takes effect.

**i** Just like any natural product, cigars require special care. They must be protected from extreme temperatures and stored in a moist environment. The ideal temperature is 15-20°C and the ideal humidity level is 65-75%. The humidifier's performance varies according to the ambient humidity and temperature.

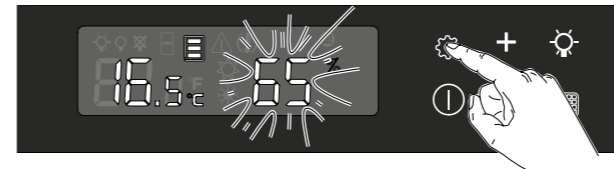

**3** Press the button to validate.  
The humidity level display will start to flash.



**4** Press the **+** or **-** keys to set the desired relative humidity level (Setting range: 65 - 85%).

**5** Press the key to validate.

On the screen, the humidity displayed is an average calculation. Depending on the number of door openings, the function of cold and warm circuits, the humidity display can vary +/-10% but without influence on the good preservation of cigars. The purpose of adopting average calculation is to avoid overreaction from the system: maintaining a proper combination of temperature and humidity ratio is a succession of modifications, which need to be driven smoothly, in a volume where parameters are not always fixed. For this reason we do not recommend comparing the average humidity ratio nor temperature with instantaneous measurements which are performed at a different location, on a smaller timeframe and by different additional sensors.

## IV- Charcoal filter meter display

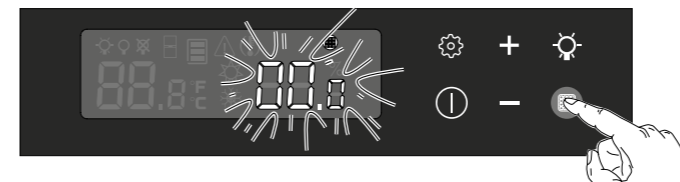

When commissioning the appliance or replacing the filter, set the meter to 365.

**1** Press the key.  
The display will flash.



**2** Press the **+** key to set to 365.



**3** Press the key to validate.  
The alarm display will disappear.

**i** The charcoal filter must be replaced every year.

You can consult the meter pressing the key.

## V- Setting the lighting mode

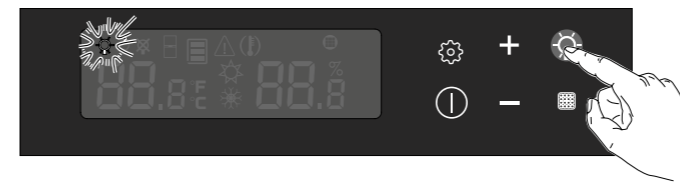

**1** Press the key.  
The indicator light of the active mode will flash.

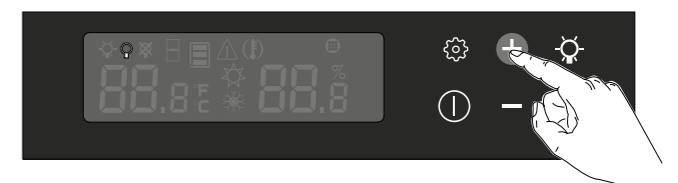

**2** Press the **+** or **-** keys to select the desired mode.

**3** Press the key to validate.

There are three lighting options:

- Permanent lighting (mood lighting for a humidifier fitted with a glass door, for example).
- Lighting when the door opens (it is off when the door is closed).
- Lighting disabled.

**! Precautions to observe:** bright light, never look directly at the beam.

Only a qualified electrician must replace the LEDs on the control panel.



## 7/ DAILY MAINTENANCE



Your EuroCave cigar humidor is a tried and tested appliance.

### Maintenance to be carried out approximately once a year

- Unplug and unload the appliance.
- Remove any particles that could block the drainage pipe located inside the humidor at the bottom.
- Clean the condenser at the back of the appliance by vacuuming it to remove any dust.
- Clean inside the compartments with water and a gentle cleaning product.
- Rinse thoroughly.
- Dry with a soft cloth.
- Replace the active charcoal filter housed in the upper breather hole of your humidor.
- Remove the charcoal filter manually. It is available from your usual stockist. It must be replaced by an original manufacturer's part.
- Check the condition of the seals. It is often necessary to clean the door seal. Cleaning with unsuitable products will cause premature ageing of the seals. Certain rules should therefore be observed: Whenever the seal is cleaned, it must be rinsed afterwards with clean water.
- No trace of cleaning product must remain on the seal. EuroCave recommends only using a mild soapy solution. If cleaning with this type of solution proves insufficient, it is possible on a one-off basis to use an ethanol-based solution, with a concentration of less than 10% ensuring that you thoroughly rinse the seal with clean water afterwards.
- Only clean the light strip with a soft cloth or microfibre cloth. Never use alcohol-based cleaning products.
- To clean the fronts of the shelves:
  - only use a soft cloth or microfibre cloth
  - only use water or a cleaning product for glass

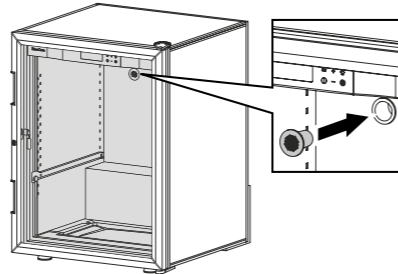

### Maintenance to be carried out once every two years

- Replace the clay ball cassettes.

### Maintenance of glass sections:

To clean the glass sections of your humidor (all doors and handle in glass supplied with the full glass doors only), use a non-abrasive soft cloth, first dampened with a suitable glass-cleaning product.







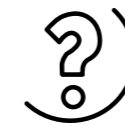

Never use a cleaning product containing acetone, turpentine, alcohol or White Spirit or synthetic thinners which could damage the front.



Regular monitoring of your humidor and reporting any faults to your stockist, will ensure that your appliance provides you with years of faithful service.



## 8/ OPERATING FAULTS

Possible incidents	Causes	Corrective action
The  pictogram is displaying	The temperature has not returned to the permitted range of $\pm 4^\circ\text{C}$	Check that the door is closed. Check the condition of the door seal. If you loaded your humidor with a large number of cigars in the last few hours, wait a while then check again. If the alarm continues, contact your EuroCave stockist.
The  pictogram is still displaying even though I took the above correct action	Operating fault	Unplug the humidor and contact your EuroCave stockist.
The  pictogram is displaying	Open door alarm	Ensure that the door is correctly closed.
The  pictogram is flashing	The relative humidity level has been $< 50\%$ for over 72 hrs	<ul style="list-style-type: none"> <li>● Add 10 cl of water to the clay ball cassette.</li> <li>● In order to know how often to add water, count the number of days separating the 1<sup>st</sup> day you added water and the day when the pictogram was displayed. After a few hours, the pictogram will disappear.</li> </ul>
The appliance cannot lower the humidity level to the required value		<ul style="list-style-type: none"> <li>● Remove the cigars from the lower section, remove the clay ball cassettes and clean the tray.</li> <li>● Remove the tube placed at the bottom of the tray. The humidity will be directly discharged out of the appliance.</li> <li>● Set the humidity level to 65% but do not install the clay ball cassettes or replace them with new ones.</li> </ul> Call your EuroCave stockist if the problem continues in spite of carrying out these different actions.
The  pictogram is displayed	Charcoal filter alarm	Replace the charcoal filter (see chapter 5).
The  pictogram is displayed	Temperature sensor fault alarm	Contact your EuroCave stockist.



If your appliance does not seem to be operating correctly, contact your EuroCave stockist.

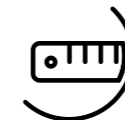

## 9/ TECHNICAL FEATURES

Cigar humidor						
Height mm	Width mm	Depth mm	Weight when empty (full glass door) kg	Permitted temperature range		
				T° min °C/°F	T° max °C/°F	
960	680	715	60	15/59	30/86	

Setting accuracy:  $\pm 1^\circ\text{C}$  ( $2^\circ\text{F}$ ), Display accuracy:  $\pm 1^\circ\text{C}$  ( $2^\circ\text{F}$ ).  
 1 – Height including the upper hinges and the feet, set to mid-height.  
 2 – Depth including a space of 29 mm at the back of the humidor used for ventilation.

### Standards

Your product complies with the following standards:

#### I – ELECTRICAL SAFETY DIRECTIVE 2014/35/EU

IEC 60335-1: 2010 + A1: 2013 + A2: 2016  
 IEC 60335-2-24: 2010 + A1: 2019 + A2: 2019

#### II – EMC DIRECTIVE 2014/30/EU

STANDARDS  
 EN 55014-1: 2017  
 EN IEC 55014-2: 2021  
 EN IEC 61000-3-2: 2019  
 EN 61000-3-3: 2013  
 EN 62233: 2008

#### III – ENVIRONMENT

DELEGATED REGULATION  
 2019/2016/EU  
 REGULATIONS  
 2017/1369/EU  
 2019/2019/EU  
 DIRECTIVE 2011/65/EU



**R600a**

Depending on the country, EuroCave humidors contain flammable refrigerant gas (R600a: ISO BUTANE)



Flammable gas. Leave the appliance away from any sources of heat.





# EUROCAVE

Leader dans le domaine de la conservation, la présentation et le service des vins depuis plus de 40 ans, EuroCave vous propose des solutions adaptées à chacun de vos besoins. Caves à vin, rangements, climatiseurs de cave, système de Vin au verre... n'hésitez pas à contacter votre revendeur EuroCave pour toute information complémentaire !

Leader in the wine preservation, presentation and service sector for over 40 years, EuroCave offers you solutions adapted to every one of your requirements. Wine cabinets, storage layouts, cellar conditioners, wine by-the-glass system... don't hesitate to contact your EuroCave dealer for further information!

Seit mehr als 40 Jahren führend im Bereich der Lagerung, der Präsentation und dem Ausschank von Weinen schlägt Ihnen EuroCave Lösungen vor, die jedem Ihrer Bedürfnisse angepasst sind: Wein-, Zigarrenklimaschränke, Weinkeller-Kompaktklimaanlagen, Geräte für den glasweisen Offenausschank, Weinkeller-Regalsysteme. Zögern Sie nicht länger, setzen Sie sich mit Ihren EuroCave-Händler in Verbindung, wenn Sie noch irgendwelche Fragen haben!

Líder en el campo de la conservación, presentación y el servicio de vinos desde hace 40 años, EuroCave le propone soluciones adaptadas a cada una de sus necesidades. Bodegas, estanterías, climatizadores de bodegas, sistemas de vinos a la copa... ¡Para toda información complementaria, no dude en contactar a su distribuidor EuroCave!

EuroCave, al meer dan 40 jaar toonaangevend op het gebied van het behoud, de presentatie en het serveren van wijn, levert oplossingen aangepast aan elke behoefte. Wijnkasten, opbergssystemen, klimaatregelaars, Vin au verre-systeem... neem gerust contact op met uw EuroCave-dealer voor aanvullende informatie!

Leader nel settore della conservazione, della presentazione e del servizio dei vini da più di 40 anni, EuroCave vi propone delle soluzioni adatte a ciascuno dei vostri bisogni. Cantinette per vini, sistemi di stoccaggio, climatizzatori da cantina, sistemi di Vino al bicchiere... non esitate a contattare il vostro rivenditore EuroCave per qualsiasi informazione complementare!

拥有40多年丰富经验，作为葡萄酒储存、展示和饮用领域的领导企业，EuroCave向您提供适合您每一种需求的解决方案。葡萄酒酒柜、储物柜、酒窖空调、单杯酒系统.....请不要犹豫，立即联系您的EuroCave经销商，获取更多信息！



[www.eurocave.com](http://www.eurocave.com)